

PM-Kerne PM Cores

PM-Kerne für Leistungsübertrager sowie für Speicherdrosseln in getakteten Stromversorgungsgeräten hoher Leistung. Ebenso für Anwendungen in der Nachrichtentechnik und Industrieelektronik.

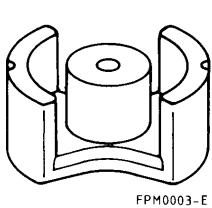

FPM0003-E

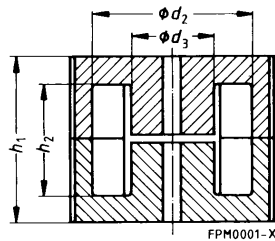
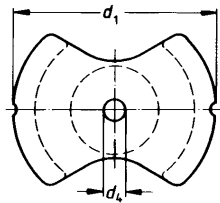

FPM0001-X

Typ Type	Hauptmaße (mm) Main dimensions (mm)					
	d_1	$\varnothing d_2$	$\varnothing d_3$	d_4	h_1	h_2
PM 50/39	50-1,7	39,0±1,3	20,0-0,6	5,4±0,2	39-0,4	26,4±0,8
PM 62/49	62-2,0	48,8±1,5	25,5-0,8	5,4±0,2	49-0,4	33,4±0,8
PM 74/59	74-2,5	57,5±1,8	29,5-1,0	5,4±0,3	59-0,6	40,7±0,8
PM 87/70	87-3,0	67,1±2,1	31,7-1,0	8,5±0,3	70-0,8	48,0±0,8
PM 114/93	114-4,5	88,0±3,7	43,0-1,4	5,4±0,4	93-1,0	63,0±1,6

Typ Type	Magnetische Formkenngrößen pro Satz Magnetic characteristics per set				
	$\Sigma I/A$ mm ⁻¹	l_e mm	A_e mm ²	A_{min} mm ²	V_e mm ³
PM 50/39	0,227	84	370	280	31000
PM 62/49	0,191	109	570	470	62000
PM 74/59	0,162	128	790	630	101000
PM 87/70	0,161	146	910	700	133000
PM 114/93	0,116	200	1720	1380	344000



Kerne/Cores				
Typ Type		Material A_L -Werte (nH) A_L values (nH)		Bestellnummer pro Satz Ordering code per set
		N 27	N 87	
PM 50/39	● ● ● ● ○ ○	250 ± 3% 630 ± 3% 1600 ± 5% 3150 ± 15% 7400 + 30/-20%	7400+30/-20%	B65646-A250-A27 B65646-A630-A27 B65646-A1600-J27 B65646-A3150-L27 B65646-A-R27 B65646-A-R87
PM 62/49	● ● ● ● ○ ○	315 ± 3% 630 ± 3% 1600 ± 5% 4000 ± 15% 9200 + 30/-20%	9200+30/-20%	B65684-A315-A27 B65684-A630-A27 B65684-A1600-J27 B65684-A4000-L27 B65684-A-R27 B65684-A-R87
PM 74/59	● ● ● ● ○ ○	315 ± 3% 630 ± 3% 2500 ± 5% 4000 ± 15% 10000 + 30/-20%	10000+30/-20%	B65686-A315-A27 B65686-A630-A27 B65686-A2500-J27 B65686-A4000-L27 B65686-A-R27 B65686-A-R87
PM 87/70	● ● ● ● ○	400 ± 3% 1000 ± 3% 2500 ± 5% 5000 ± 15% 12000 + 30/-20%		B65713-A400-A27 B65713-A1000-A27 B65713-A2500-J27 B65713-A5000-L27 B65713-A-R27
PM 114/93	● ● ● ● ○	630 ± 3% 1000 ± 3% 2500 ± 5% 6300 ± 15% 16000 + 30/-20%		B65733-A630-A27 B65733-A1000-A27 B65733-A2500-J27 B65733-A6300-L27 B65733-A-R27

● = mit Luftspalt/gapped
○ = ohne Luftspalt/ungapped

PM cores for power transformers and energy-storage chokes in high-performance switch-mode power supplies. Also suitable for applications in telecommunications and industrial electronics.



Zubehör/Accessories			Bausatz/Set	
Spulenkörper Coil formers Kammern Sections	Lötanschlüsse Solder pins	Bestellnummer Ordering code	Halterung ¹⁾ Mounting assemblies ¹⁾	Einbaumaße (mm) Länge x Breite x Höhe ²⁾ Mounting dimensions (mm) Length x width x height ²⁾
1 1	14 –	B65647-B1014-T1 B65647-A1000-T1	B65647-A2000	65 x 52 x 45
1 1	16 –	B65685-B1016-T1 B65685-A1000-T1	B65685-A2000	76 x 64 x 55
1 1	18 –	B65687-A1018-T1 B65687-A1000-T1	B65687-A2000	85,5 x 75 x 65
1 1	20 –	B65714-K1020-T1 B65714-J1000-T1	B65714-A2000	101 x 87 x 72
1	–	B65734-B1000-T1	–	114 x 92 x 93

¹⁾ Komplette Halterung mit Muttern und Scheiben
Complete mounting assembly incl. nuts and washers

²⁾ Höhe über Montagefläche
Height above mounting plane